

PROPOSED PLAN OF A SIXTEEN STORED RESIDENTIAL BUILDING AT HOLDING NO : 115, GOLAGHATA ROAD, KOLKATA-700048; MOUZA - GOLAGHATA; J.L. NO : 27; C.S.DAG NO : 104; KHATIAN: 72; P.S.- LAKE TOWN; WARD NO.- 35; UNDER S.D.D.M.: DIST.- 24 PGS (N).

NAME OF OWNER : B.P.PODDAR FOUNDATION FOR EDUCATION

AREA STATEMENT :  
 AREA OF LAND (AS PER DEED) : 32 K-12 CH- 36 SFT (2194.79 SQ.M.)  
 AREA OF LAND (AS PER MEASUREMENT) : 1604.69 SQ.M.  
 PERMISSIBLE COVERED AREA (50%) : 802.345 SQ.M.  
 COVERED AREA OF GROUND FLOOR : 549.57 sq.m  
 COVERED AREA OF 1ST TO 15TH FLOOR : 557.81 sq.m (EACH)  
 TOTAL COV. AREA : 8916.72 SQ.M.  
 VOLUME OF PROP. CONSTRUCTION : 30035 CU.M.

SCHEDULE OF DOORS & WINDOWS							
TYPE	SILL	LINTEL	SIZE	TYPE	SILL	LINTEL	SIZE
GD	-	2100	1800x2100	W	450	2100	1500x1650
D1	-	2100	1100x2100	W1	450	2100	1500x1650
D2	-	2100	900x2100	W2	450	2100	1200x1650
D3	-	2100	750x2100	W3	450	2100	900x1650
DW	-	2100	1800x2100	WK	1050	2100	900x1650
				WS	900	2100	1200x1200
				WS1	900	2100	900x1200
				V	1200	2100	500x900

SHEET NO.-01/02  
 DRAWING TITLE: BLOCK - 1  
 GROUND FLOOR PLAN, SITE PLAN, LOCATION PLAN, DETAILS OF U.G.W.R AND SEPTIC TANK.

CERTIFICATE OF OWNER  
 CERTIFIED THAT I SHALL NOT ON A LATER DATE MAKE ANY ADDITION OR ALTERATION TO THIS PLAN, SO AS TO CONVERT IT FOR MY USE OR ALLOW IT TO BE USED FOR SEPARATE FLATS/FLOOR/STORY.  
 CERTIFIED THAT I HAVE GONE THROUGH THE BUILDING RULES FOR S.D.D.M. & ALSO UNDERTAKE TO ABIDE BY THOSE RULES DURING & AFTER CONSTRUCTION OF BUILDING.  
 CERTIFIED THAT I ALSO UNDERTAKE TO REPORT OF COMMENCEMENT BEFORE SEVEN DAYS AND COMPLETION WOULD BE REPORTED WITHIN 30 DAYS. I ALSO UNDERTAKE TO REPORT THAT THERE IS NO COURT CASE OR ANY COMPLAINTS FROM ANY CORNER IN RESPECT OF MY PROPERTY AS PER PLAN, S.D.D.M. WILL NOT BE LIABLE FOR ANY TYPE OF DISPUTE IF ARISES IN FUTURE FURTHER THERE IS NO TENANT IN THE AFORESAID PREMISES.

CERTIFICATE OF BUILDING PLAN  
 I/WE DO HEREBY CERTIFY THAT PLANS, ELEVATIONS AND SECTIONS AND OTHER STRUCTURAL DETAILS OF THE PROPOSED BUILDING AT HOLDING NO. 115, GOLAGHATA ROAD, KOLKATA-700048, HAVE BEEN PREPARED IN CONFORMITY WITH ALL RELEVANT PROVISION UNDER THE WEST BENGAL MUNICIPALITY BUILDING RULES, 2007. THIS ALSO TO CERTIFY THAT ALL RELEVANT NO OBJECTION CERTIFICATES FROM THE RESPECTIVE AUTHORITIES SUCH AS FIRE AND EMERGENCY SERVICES DEPARTMENT AND PORT AUTHORITY, TELECOMMUNICATION DEPARTMENT ETC. AS APPLICABLE IN THIS REGARD, ARE ALSO ENCLOSED WITH THE APPLICATION FOR SEEKING APPROVAL OF THE PLAN TO CONSTRUCT ADDITION TO ALTERATION OF THE BUILDING ON THE SAID PLOT.

CERTIFICATE OF STRUCTURAL STABILITY  
 I/WE HEREBY CERTIFY THAT THE FOUNDATION AND SUPERSTRUCTURE OF THE BUILDING PROPOSED FOR CONSTRUCTION AT HOLDING NO. 115, GOLAGHATA ROAD, KOLKATA-700048, HAVE BEEN PERSONALLY INSPECTED AND SO DESIGNED BY ME/US WILL MAKE SUCH FOUNDATION AND SUPER STRUCTURE SAFE IN ALL RESPECT INCLUDING THE CONSIDERATION OF BEARING CAPACITY AND SETTLEMENT OF SOIL AND OTHER CONDITIONS, IF ANY CONFORMING TO ALL STIPULATIONS OF ALL RELEVANT IS CODE OF PRACTICE AND NATIONAL BUILDING CODE.

CERTIFICATE OF STRUCTURAL REVIEWER  
 I/WE HEREBY CERTIFY THAT THE BUILDING SITE PROPOSED FOR CONSTRUCTION AT HOLDING NO. 115, GOLAGHATA ROAD, KOLKATA-700048, HAS BEEN VISITED BY ME/US AND ALL THE DESIGNS, DRAWINGS SPECIFY THE DRAWING NUMBER, SERIAL NO., SOIL TEST REPORT AND LOAD TEST RESULTS FOR FOUNDATION AND SUPERSTRUCTURE HAVE BEEN DULY REVIEWED CONFORMING TO STIPULATIONS OF ALL LATEST RELEVANT IS CODE OF PRACTICE AND NATIONAL BUILDING CODE AND IT IS FOUND THAT EVERYTHING IS COMPLETELY IN ORDER AND THE PROPOSED FOUNDATION AND SUPER STRUCTURE ARE SAFE IN ALL RESPECT.

SIGNATURE OF OWNER: Mahesh Kumar Sharma  
 SIGNATURE OF LICENSED BUILDING SURVEYOR/ARCHITECT: Dhiman Bhattacharjee  
 SIGNATURE OF STRUCTURAL ENGINEER: Dhiman Bhattacharjee  
 SIGNATURE OF GEOTECHNICAL ENGINEER: [Blank]

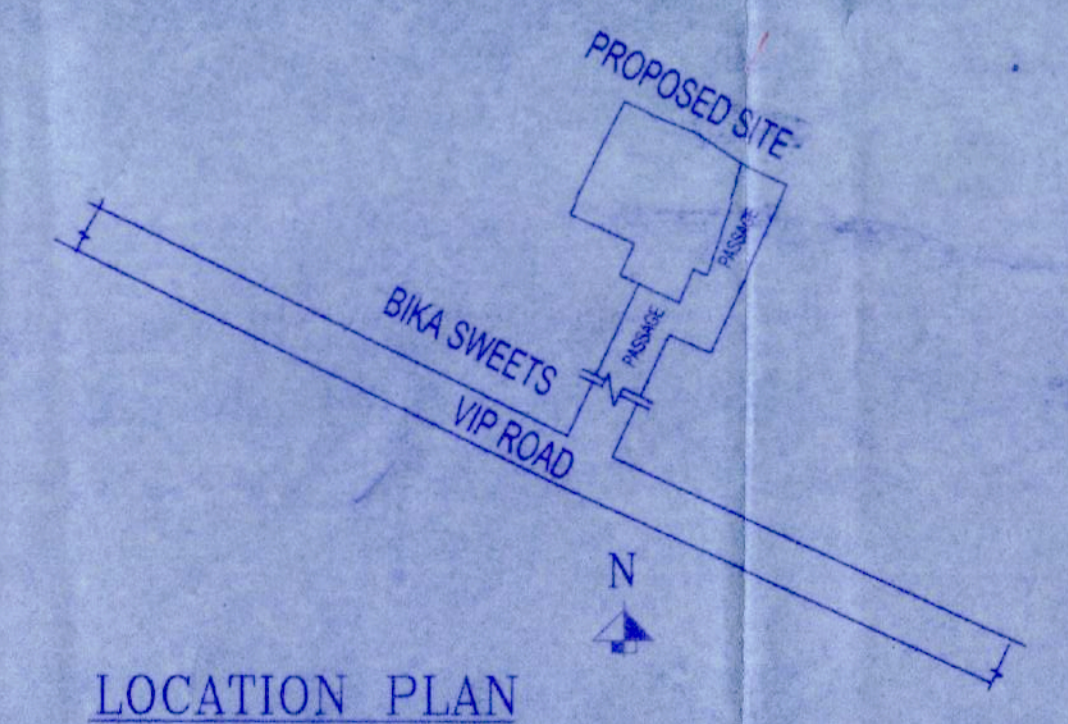
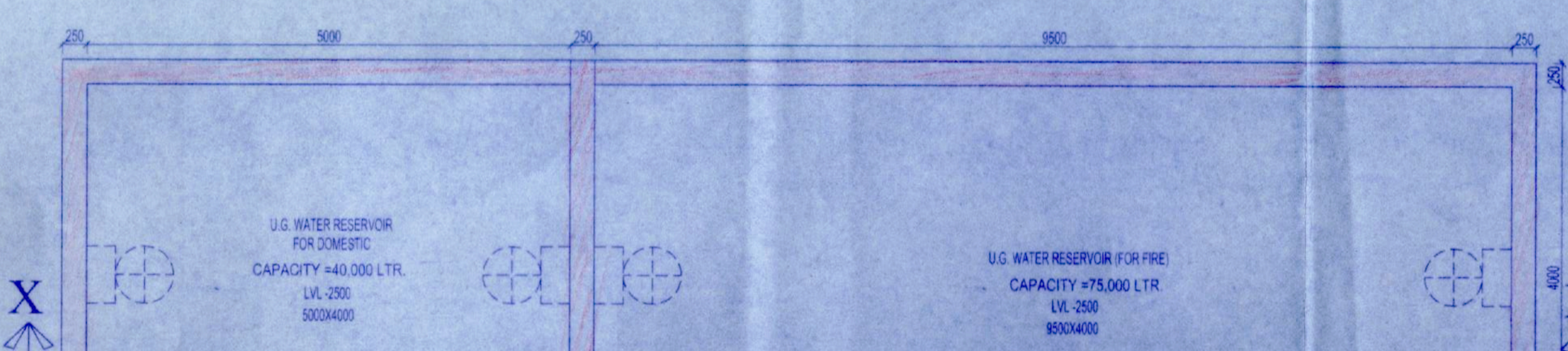
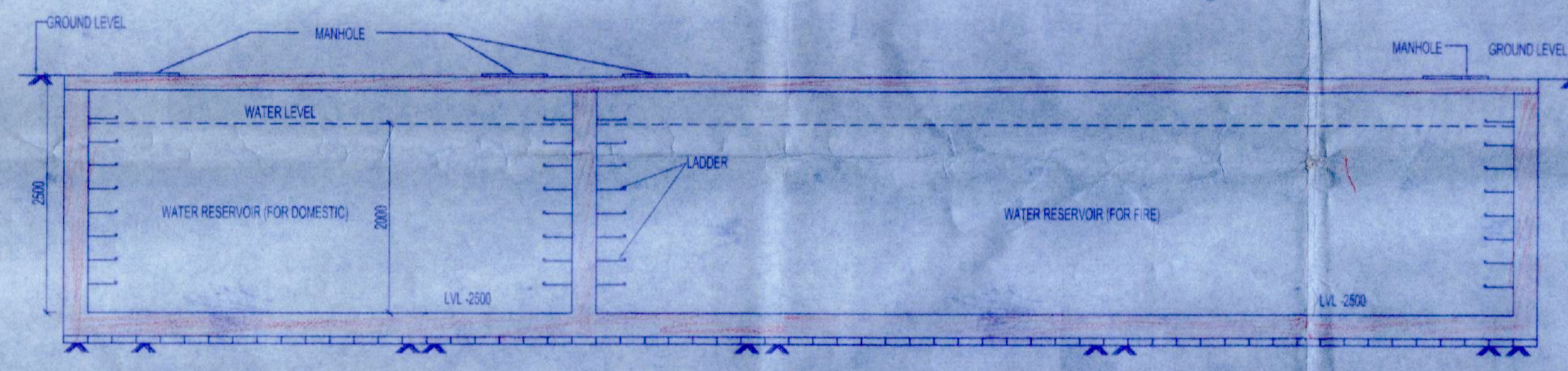
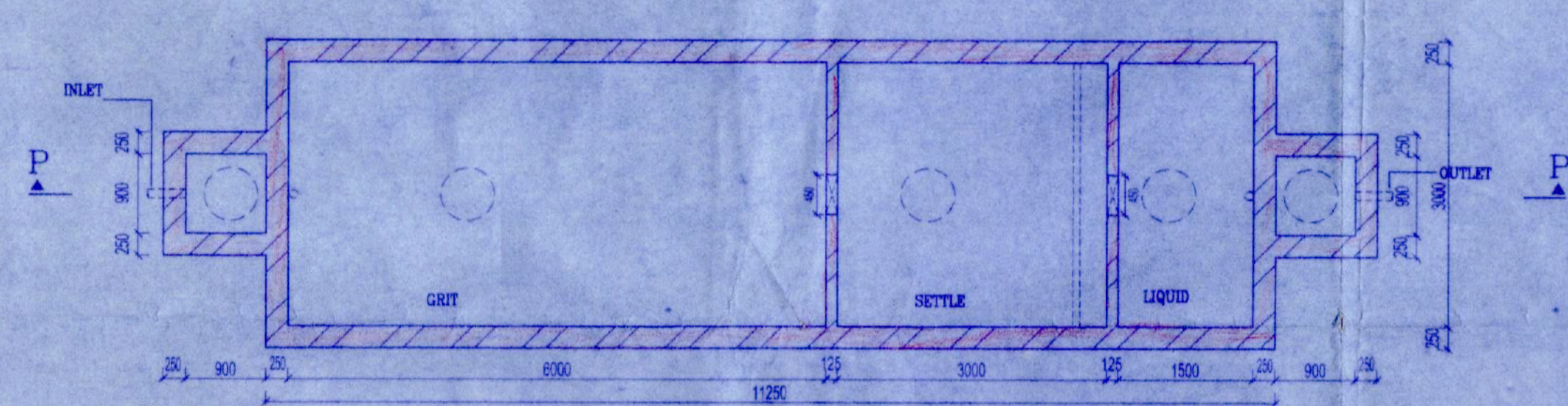
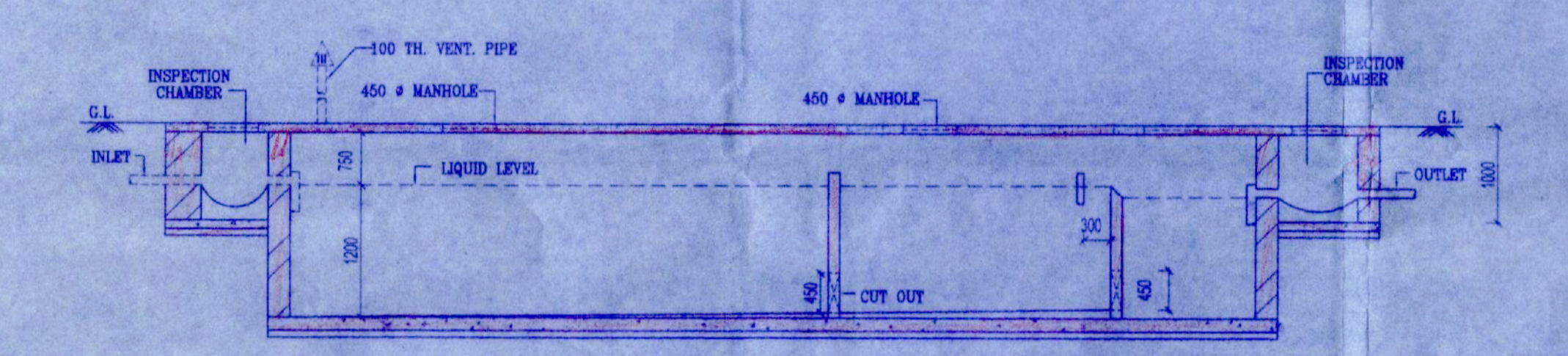
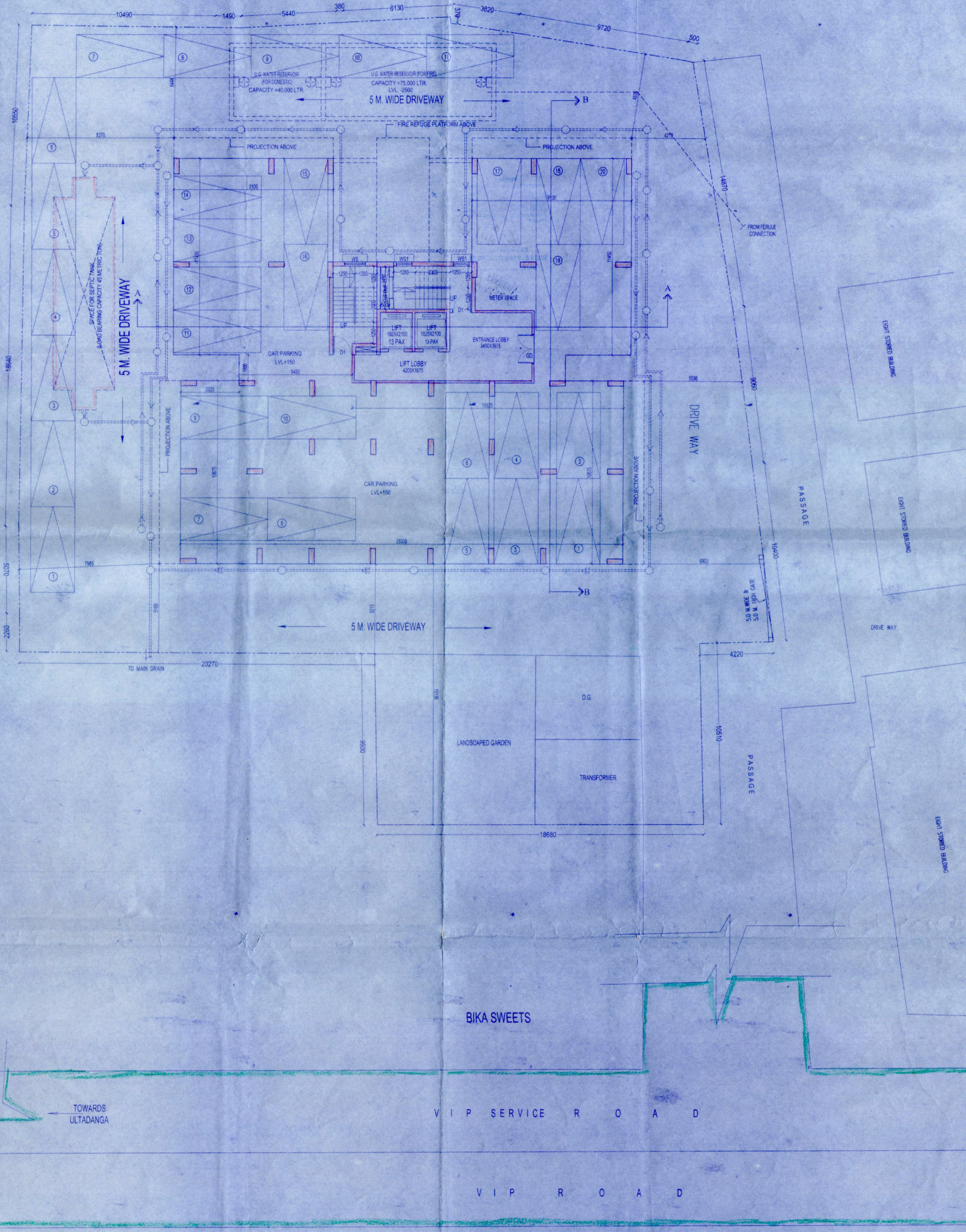

GROUND FLOOR PLAN SCALE\* 1:100

DETAIL OF U.G.W.R SCALE\* 1:50

SECTION AT X-Y

DETAIL OF SEPTIC TANK (250 USERS) SCALE\* 1:50

SECTION AT P-P

SIGNATURE OF STRUCTURAL REVIEWER				
DATE	JOB NO.	DEALT	CHECKED	SHEET NO.
15.07.2022	ARCH/737/2022	ASCAR	MITHUN	1 OF 2
SCALE: 1:50, 100, 600, 4000			ARCHITECT	